



F132 Filter Check Valve User Manual

Please read this manual in details before using the product and keep it properly in order to consult in the future.
0WRX.466.783

1. Product Parameter

Suitable Water Pressure	0.1-0.6MPa
Suitable Water Temperature	5°C-50°C
Inlet and Outlet Size	G3/4
Flow Rate	3.5m ³ /h
Filtration Accuracy	0.25mm
Appearance	141mm×79mm

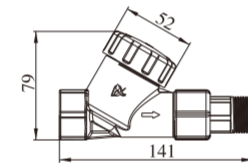

2. Product Structure

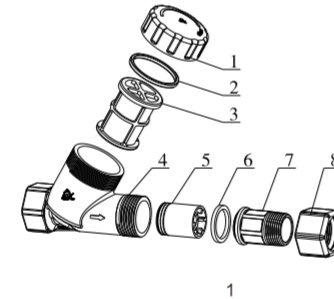

Item	Description	Quantity	Part No.
1	Top Cover	1	8315135
2	Sealing Ring	1	8370147
3	Filtration Net	1	5336016
4	Valve Body	1	5022165
5	Check Valve	1	5467011
6	Sealing Gasket	1	8371053
7	Connector	1	8458236
8	Nut	1	8945056

3. Product Characteristics

1. Y type structure, small water resistance, operate with micro differential pressure;
2. Adopt 304 stainless steel filtration net, easy disassemble and wash;
3. Adopt patented shock absorption design. It has good ability to resist water hammer impact.
4. The connector adopts copper materials, and valve body adopts high strength PPE materials, which is safe and reliable;
5. Retain large particles of sediment and protect the check valve core;

6. Install downstream of the water meter, prevent water flowing back;
7. Adopt ceramic check valve core, which is more wear-resistant and easy to maintain.

4. Installation

This product can be installed on the main pipe of the house (after the water meter) to prevent the water flowing back from the water tank and other equipment.

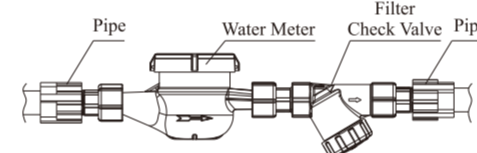

Suggestion: When installing, the direction of the filtration net should be downward as above figure shows. When removing the filtration net, prevent the sediment from falling back into the pipeline.

5. Clean Filtration Net

Proceed as follows:

1. Close the main water inlet valve;
2. Unscrew the top cover counterclockwise and take out the filtration net for cleaning;

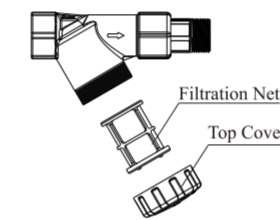

3. After cleaning the filtration net, tighten the upper cover and ensure that the sealing ring of the upper cover is in good condition;

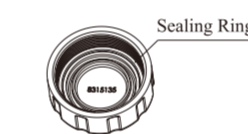

4. Slowly turn on the main water inlet valve and check whether there is leakage.

Please note: due to the differences in water quality and water usage in different places, the time of cleaning the filtration net is subject to the actual situation.

6. Precautions

1. If you need to purchase accessories due to installation requirements, please choose high-quality products.
2. The thread size of all our products is produced according to the standard. When selecting the matching parts, the user should choose the standard parts produced by the high-quality manufacturers to prevent the thread from being unable to match, the thread slipping, the thread misalignment, etc.
3. The User Manual is an instructional document for the correct use of this product. Users should do the operation, daily inspection and maintenance in strict accordance with the User Manual.
4. The applicable water source of this product is municipal tap water, the applicable water pressure is 0.1-0.6MPa, and the applicable water temperature is 5°C-50°C. It is strictly forbidden to use it beyond the working conditions.
5. When the valve leaks, the main water inlet should be cut off immediately, and the local distributor should be contacted in time.
6. Please clean the filtration net regularly to prevent affecting household water use.
7. The company will not bear any responsibility for the consequences caused by not operating in accordance with the above precautions.



WENZHOU RUNXIN MANUFACTURING MACHINE CO., LTD.

ADD.: NO.169, RUNXIN ROAD, SHANFU TOWN,
WENZHOU, ZHEJIANG, CHINA.
TEL.: 0086-577-88630038, 88576512, 85956057
FAX: 0086-577-88633258
E-MAIL: sales@run-xin.com http://www.run-xin.com
Rev.A.2207